

mm [inch]

475.0-800.0 [18.70-31.50]

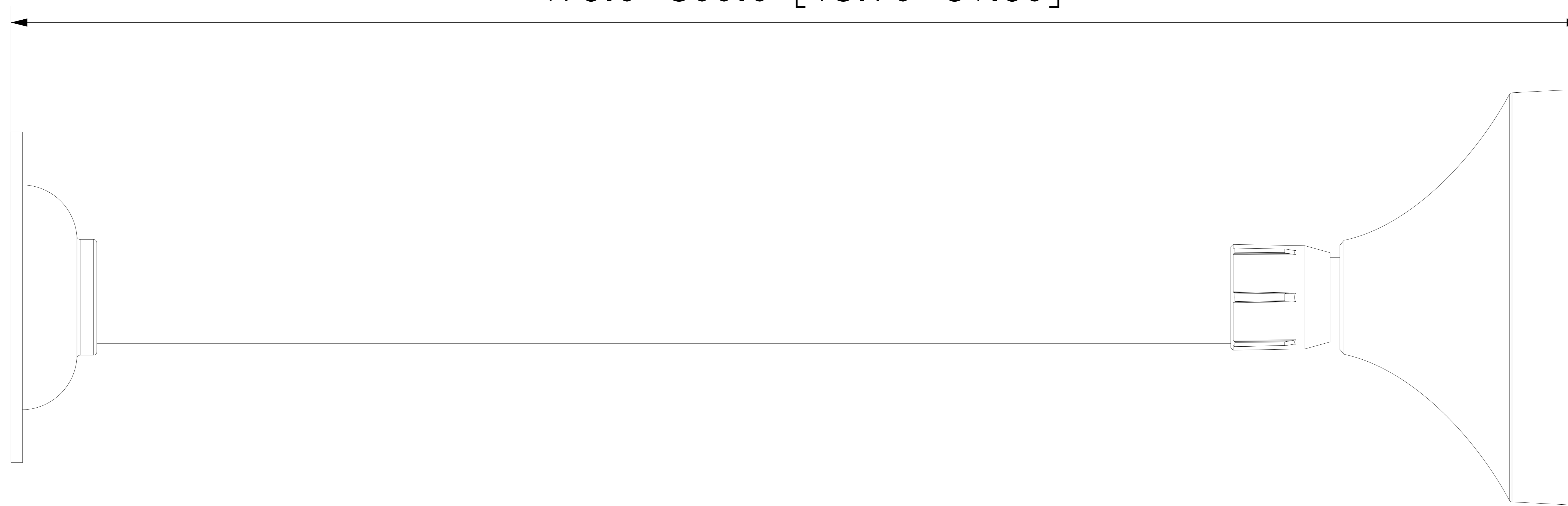

$\Phi 46.0$ [$\Phi 1.81$]

30.6 [1.20]

21.0 [0.83]

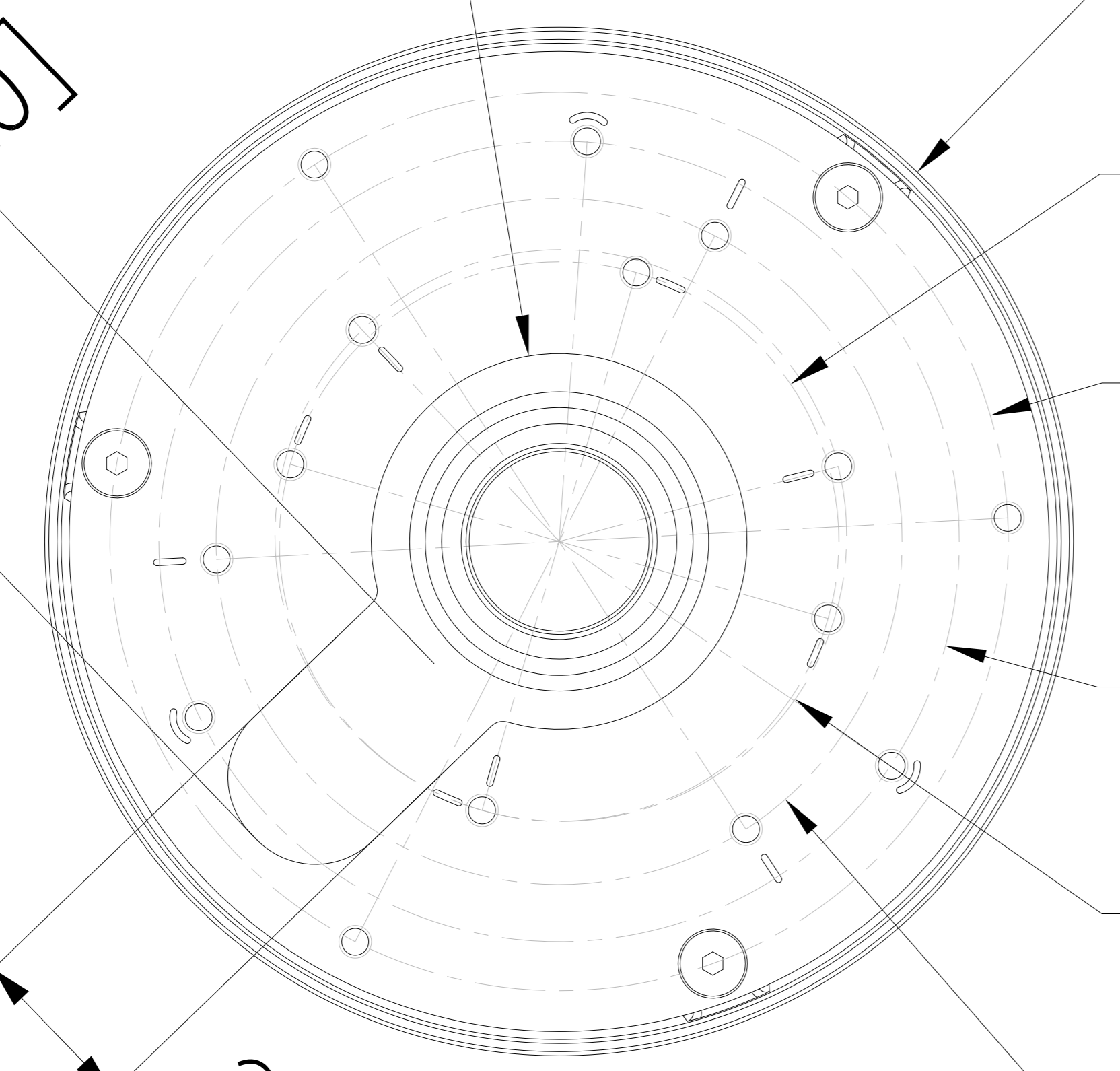

$\Phi 125.9$ [$\Phi 4.96$]

$\Phi 68.5$ [$\Phi 2.70$](4-M4)

$\Phi 110.0$ [$\Phi 4.33$](3-M4)

$\Phi 98.0$ [$\Phi 3.86$](3-M4)

$\Phi 70.0$ [$\Phi 2.76$](3-M4)

$\Phi 84.0$ [$\Phi 3.31$](3-M4)

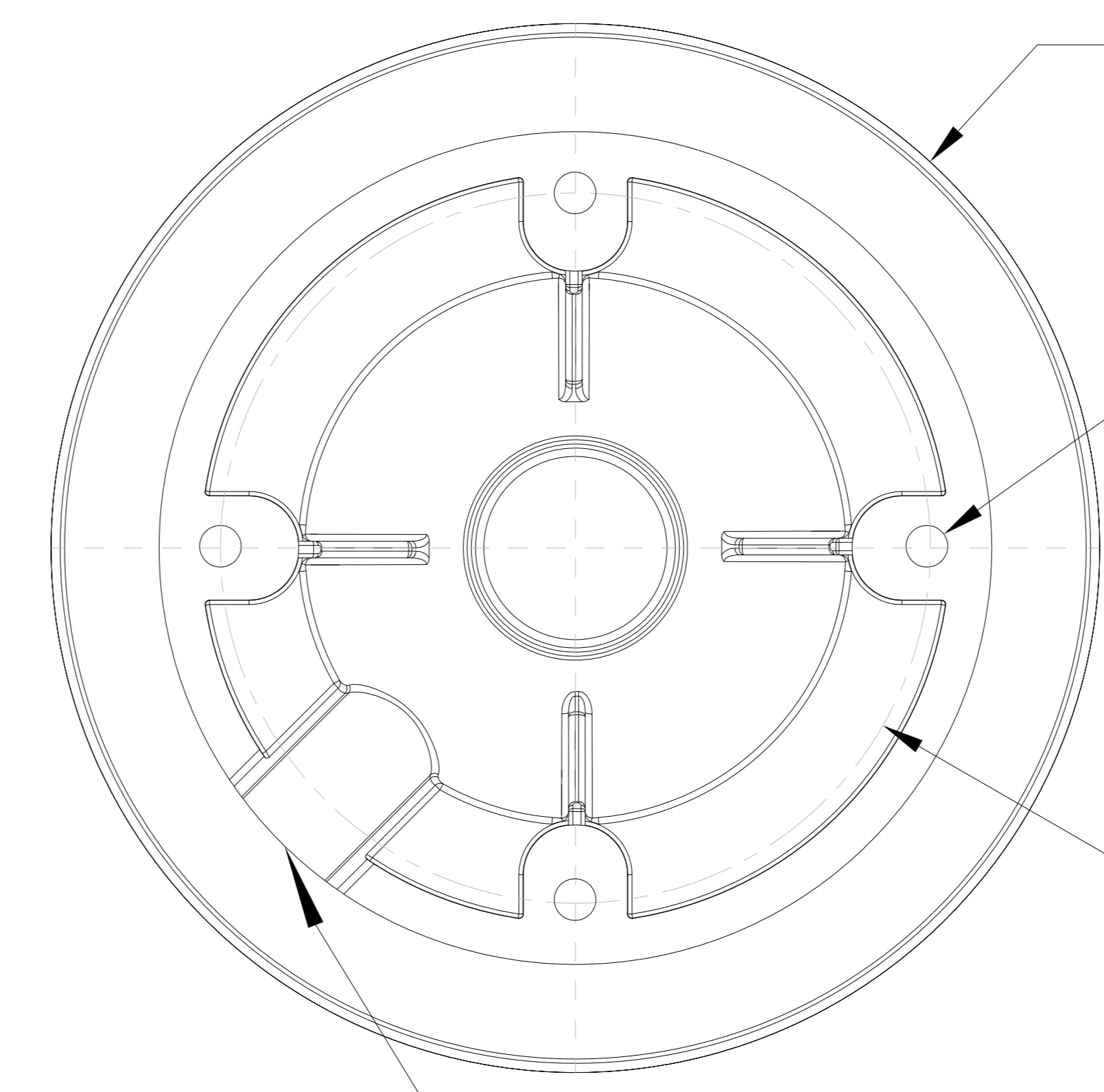

$\Phi 125.9$ [$\Phi 4.96$]

$\Phi 5.0$ [$\Phi 0.20$]

$\Phi 85.3$ [$\Phi 3.36$]

$\Phi 15.0$ [$\Phi 0.59$]