

SNI-1PI 1 CHANNEL INDUSTRIAL 1Gb 30/60/90W POE INJECTOR

WISENET

Industrial Ethernet Solutions

Wisenet industrial PoE injectors provide 30W or 60/90W of power injection on one 1Gb Ethernet port. Provided with dual power supply inputs and robust surge protection as standard ensures maximum system reliability.



[SNI-1PI]

/ OVERVIEW

Designed in a compact DIN rail or wall mount housing, the Wisenet series industrial Power over Ethernet (PoE) injectors are ideally suited for providing power to remote edge network devices.

Supporting both IEEE802.3at 30W and IEEE802.3bt 60/90W they are suitable for powering the latest high powered PoE devices over a wide industrial operating temperature range.

Designed as standard single channel injectors supporting 1Gb Ethernet.

Fitted with dual redundant power inputs and robust surge protection ensures maximum operating reliability and the highest levels of performance.

/ FEATURES

- Compact size – ideal for confined spaces, including camera poles and roadside cabinets
- -40°C to +75°C temperature maintains performance in extreme conditions
- Plug & Play – no need for any user configuration
- DIN rail mountable – quick to install and remove for maintenance
- RJ45 ports support 1Gb speeds
- Dual redundant power inputs
- Supports 15W, 30W, 60W and 90W PoE
- Integrated surge protection with up to 20kA discharge capability for maximum protection in harsh environments
- Designed in the USA & UK. Manufactured in the United Kingdom
- Lifetime Support Warranty

Specifications.

Standards.

IEEE802.3i	10Base-T
IEEE802.3u	100Base-TX
IEEE802.3ab	1000Base-T
IEEE802.3af	15W PoE
IEEE802.3at	30W PoE+
IEEE802.3bt	60 & 90W PoE

Jumbo Frames	Transparent to Jumbo Frames
VLAN Support	Transparent to VLAN traffic
Multicast Support	Transparent to Multicast traffic

Interface.

LED Indicators	2x Power PoE
RJ45 Ports	2x 10/100/1000T(X) RJ45 with 2 kV Isolation Protection
Power	1x 4-way Screw Terminal

Power.

Power Inputs	2
Operating Voltage	48-56V _{DC} (30W PoE Mode) 52-56V _{DC} (60/90W PoE Mode)
Power Consumption	2W Max (without PoE Load)
PSE Modes	Mode A, Mode B
Protection	Reverse Polarity, Overload Current

Surge Protection*.

Technology	GDT
Nominal Line Voltage	48-57V _{DC}
Max DC Voltage	75V _{DC}
Protection Level	75V _{DC} (C3 Category Line/Line)
Impulse Current	2kA (D1 Category 10/350µs x 1)
Line/Line Nominal Discharge Current	2kA (C2 Category)
Line/Earth Nominal Discharge Current	10kA (C2 Category 8/20µs x 10)
IEC 61000-4-5 (Surge)	20kA (8/20µs x 1)
Pinout	(1-2)(3-6)(4-5)(7-8)
Failsafe Mode	Short-Circuit / Cut-Off
Disconnect Indicator	Transmission Interrupt

*Earth must be connected for protection

Packaging.

Shipping Weight	0.57kg / 1.26lb
Dimensions	(W x D x H) 220 x 170 x 40 mm 8.66 x 6.69 x 1.57 in

Mechanical.

Housing	Anodised Aluminium
Dimensions:	(W x D x H) 37 x 88 x 107 mm 1.46 x 3.46 x 4.21 in
(Excluding Wall Brackets)	
IP Rating	IP40
Installation	Wall Mount or DIN-Rail
Weight	0.44kg / 0.97lb

Environmental.

Operating Temp.	-40 to +75°C / -40 to +167°F
Storage Temp.	-40 to +85°C / -40 to +185°F
Humidity	5% to 95% (non-condensing)
MTBF	>500,000 hours
MTBF Standard	Telcordia SR-332 GF 30°C
Heat Dissipation	109 BTU/h (30W PoE) 212 BTU/h (60W PoE) 317 BTU/h (90W PoE)
Cooling	Passive Cooling
Noise Level	0 dBA

Regulatory.

Safety	IEC/EN 62368-1
EMI	EN 55032 Class A CISPR 32 FCC Part 15B Class A
EMS	EN 61000-4-2 (ESD) EN 61000-4-3 (RS) EN 61000-4-4 (EFT) EN 61000-4-5 (Surge) EN 61000-4-6 (CS) EN 61000-4-8 (PFMF)
Shock	IEC 60068-2-27
Free Fall	IEC 60068-2-32
Vibration	IEC 60068-2-6
Surge	IEC/EN 61643-21
Environmental	Reach RoHS WEEE
Supply Chain	NDA & TAA Compliant
Designed to meet	NEMA TS2 & EN 50121-4

Part Numbers.

1Gb Industrial PoE Injectors

SNI-1PI	Industrial 1 Port PoE Injector, 1 x 10/100/1000Base-T(x) RJ45 Port (Input), 1 x 10/100/1000Base-T(x) RJ45 Port With 802.3bt 30/60/90W PoE (Output)
---------	--

Included Accessories.

DIN Rail Adapter	Rear Mounted Metal DIN Rail Clip & Screws For DIN Rail Mounting
Wall Mounting Brackets	2x Wall Mouting Brackets & Screws For Wall / Surface Mouting

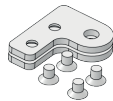
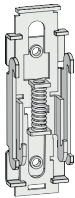

Recommended PSUs.

AMGPSU-I48-P60	DIN-Rail Mounting Industrial Grade PSU, -40 to +70°C, 43-56VDC, 60W
AMGPSU-I48-P120	DIN-Rail Mounting Industrial Grade PSU, -40 to +70°C, 47-53VDC, 120W*
AMGPSU-I48-P240	DIN-Rail Mounting Industrial Grade PSU, -40 to +70°C, 48-53VDC, 240W*

*Also available with no exposed mains terminals and direct IEC input. Order with -IEC at the end of the part code (e.g. AMGPSU-I48-P120-IEC)