

# MEDUSA

## UNIVERSAL DOME HOUSING FOR DISCREET SURVEILLANCE

### MAIN FEATURES

Patented top-opening system

Made of aluminium with bubble in acrylic

Indoor / Outdoor

IP66

Wall, ceiling or parapet application with cable management brackets

Universal internal adapter suitable for the most popular speed domes and network PTZ cameras on the market, like: AXIS, PANASONIC, SONY, JVC, CANON, ACTi, GRANDEYE, COMPRO TECHNOLOGIES, etc

Transparent or smoked bubble

Special adapter for several speed domes

### DESCRIPTION

Medusa is ideal for discreet surveillance in outdoor public areas such as monitoring of towns, shopping malls, airports, train stations.

Its special design allows the camouflage as a normal lighting system.

The MEDUSA dome housing offers a unique top-opening system, designed to give easy access to all cabling, connections and the dome camera for an incredibly comfortable installation and service.

The lower semisphere is available in clear or smoked acrylic.

Different mounting options are available, all with internal cable management: wall bracket, corner and pole adapters.



MEDUSA + DBH06



MEDUSA + DBH06 + PTCC1



MEDUSA + DBH06 + DBHWGC

### AVAILABLE MODELS

#### Dome enclosure

DBH18K0F022	Dome enclosure with sunshield and smoked bubble (camera adapter not included)
DBH18K0F028	Dome enclosure with sunshield and clear bubble (camera adapter not included)

#### Internal camera adapters

ODBH18H110	Camera adapter with fan-assisted heater IN 100-240Vac and camera power supply OUT 100/240Vac or 12Vdc, 3A max
ODBH18H211	Camera adapter with fan-assisted heater IN 24Vac
ODBH18H114	Camera adapter for SONY SNC-RX-530, SNC-RX-550, SNC-RX-570, SNC-RH-124P, SNC-RS-44P, SNC-RS-46P, with fan-assisted heater IN 100-240Vac, camera power supply OUT 12Vdc, 3A

**TECHNICAL DATA**

**GENERAL**

Constructed from die-cast aluminium  
 Epoxy polyester powder painting, RAL9002 colour  
 Lower hemisphere: in transparent or smoked acrylic (in this case the loss of luminosity is 1 lux)  
 Sunshield in ABS for outdoor, RAL9002 colour

**MECHANICAL**

External dimensions with sunshield  $\varnothing$  351x335mm (14x13in)  
 External dimensions without sunshield:  $\varnothing$  314x322mm (12x13in)  
 Cable glands: 3xM16 allowing  $\varnothing$  cable 3,5-7mm (0.1-0.3in), 1xM12 allowing  $\varnothing$  cable 5-10mm (0.2-0.4in)  
 Unit weight: 4.2kg (9.3lb) ( without camera adaptor)

**ELECTRICAL**

Heater (Ton  $15^{\circ}\text{C} \pm 3^{\circ}\text{C}$  ( $59^{\circ}\text{F} \pm 5^{\circ}\text{F}$ ), Toff  $22^{\circ}\text{C} \pm 3^{\circ}\text{C}$  ( $77^{\circ}\text{F} \pm 5^{\circ}\text{F}$ ))

- IN 24Vac, consumption 24W max
- IN 100/240Vac, consumption 44W max

Camera power supply included with internal adapter

- IN 100/240Vac, 50/60Hz, OUT 12Vdc, 3A max
- IN 100/240Vac, 50-60Hz, OUT 24Vdc, 1.5A max
- IN 230Vac, 50/60Hz, OUT 24Vac, 2A max
- IN 24Vac/24Vdc, 50/60Hz, OUT 12Vdc, 2A max

Heater fan assistant, continuous duty (Ton  $15^{\circ}\text{C} \pm 3^{\circ}\text{C}$  ( $59^{\circ}\text{F} \pm 5^{\circ}\text{F}$ ), Toff  $22^{\circ}\text{C} \pm 3^{\circ}\text{C}$  ( $77^{\circ}\text{F} \pm 5^{\circ}\text{F}$ ))

- IN 12Vdc, consumption 4W max

**ENVIRONMENT**

Indoor/Outdoor  
 Operating temperature with heating:  $-20^{\circ}\text{C}$  /  $+60^{\circ}\text{C}$  ( $-4^{\circ}\text{F}$  /  $+140^{\circ}\text{F}$ )

**CERTIFICATIONS**

CE EN61000-6-3, EN60950-1, EN50130-4  
 IP66 EN60529

**BRACKETS AND ADAPTORS**

DBH06	Cable management wall mount
DBH07	Cable management ceiling / parapet mount
PTCC1	Pole mount adaptor
DBHWGC	Pole adapter $\varnothing$ 210mm, max 225mm (8.2in, max 8.9in)
WCWGC	Corner mount adaptor

**SPARE PARTS**

ODBH18PLFR	Smoked bubble
ODBH18PLTR	Transparent bubble

**PACKAGE**

Model Number	Weight	Dimensions (WxHxL)	Master carton
DBH18K0F022	5.3kg (12lb)	38x38x41cm (15x15x16in)	18

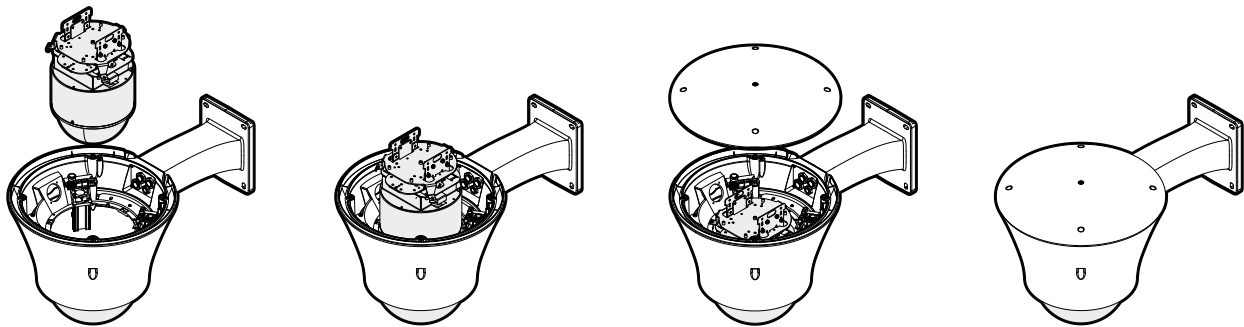

EASY INSTALLING IN 4 STEPS.

**TECHNICAL DRAWINGS**

Sizes in millimeters.

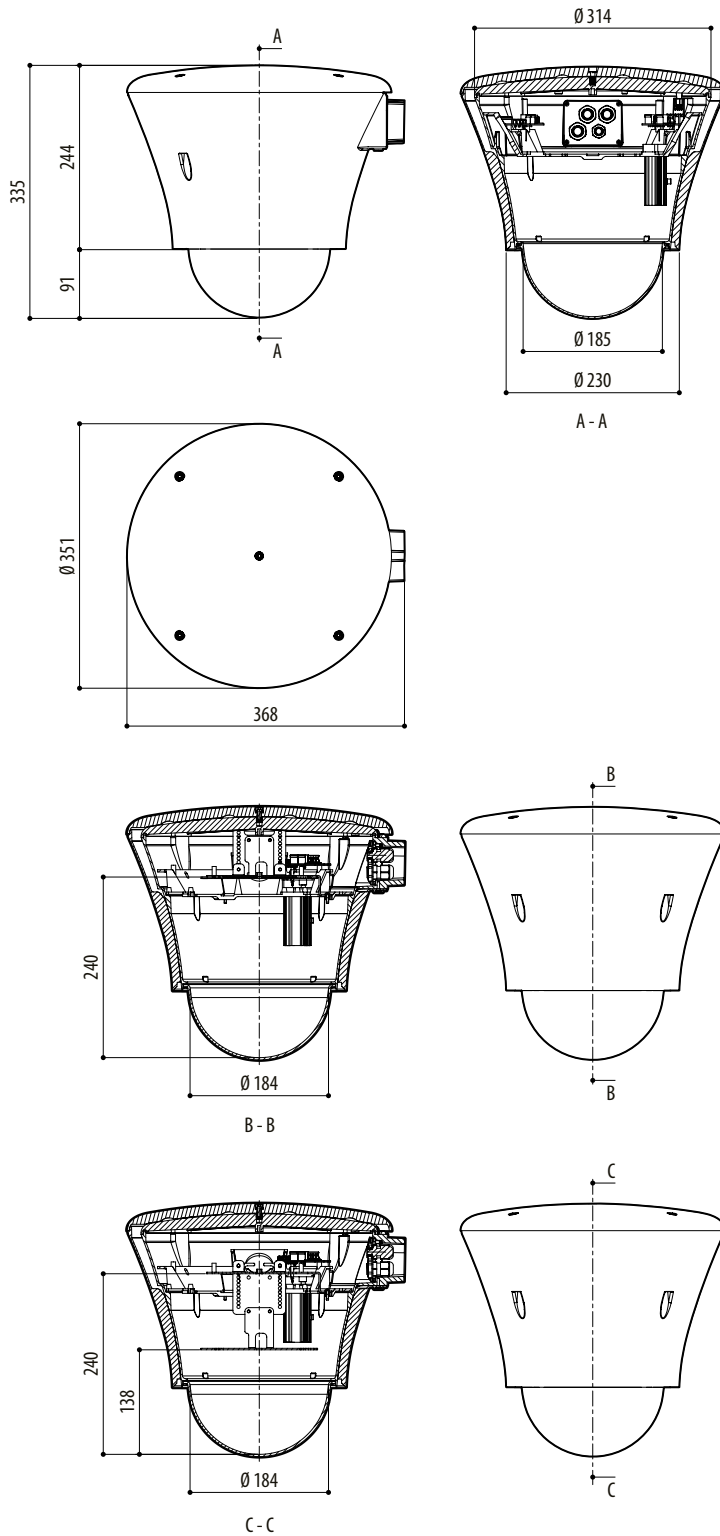

MEDUSA

