

AXIS T93F Housing Series

Robust and sleek housings with smart features



- > Protection against water, dust and corrosion
- > Impact resistant
- > Wide temperature range
- > Lightweight
- > Included wall mount

AXIS T93F Series comprises two flexible housings suitable for Axis' fixed cameras. Thanks to advanced engineering know-how and sophisticated design, they protect the network camera in adverse indoor and outdoor conditions.

AXIS T93F Housing Series is available in two models: AXIS T93F05 Protective Housing and AXIS T93F20 Outdoor Housing.

AXIS T93F Series features IP66 and NEMA 4X protection rating against the ingress of dust, windblown dust, rain, high pressure water jets from any direction, hose-directed water, and damage from external ice formation. In addition, it is IK10-rated for protection against impact and vandal acts. The plastic casing protects from the risk of corrosion and is installer-friendly thanks to the low weight.

Easy and quick installation using Power over Ethernet connection. The network cable is protected in the wall mount to enhance the vandal protection and remove the risk for solar degradation. To increase security and to detect if the housing is opened, there is a dedicated slot for an optional intrusion alarm switch. The Arctic Temperature Control functionality ensures that the cameras can start up even at -40°C (-40°F) following a power failure.

AXIS T93F Series comes with a wall mount and an integrated sun cap. AXIS T94R01P Conduit Back Box, and AXIS Corridor Format Bracket A are available as optional accessories to increase installation flexibility.



With AXIS T94R01P Conduit Back Box

Technical Specifications - AXIS T93F Housing Series

Models	AXIS T93F05 Protective Housing AXIS T93F20 Outdoor Housing	Approvals	EN 50581, IEC/EN/UL 60950-1, IEC/EN/UL 60950-22, IEC/EN 60529 IP66, NEMA 250 Type 4X, IEC 60721-4-3 Class 4M4, IEC 60068-2-6, IEC 60068-2-27, IEC/EN 62262 IK10 AXIS T93F20: EN 55022 Class B, EN 50121-4, EN 61000-3-2, EN 61000-3-3, EN 61000-6-1, EN 61000-6-2, EN 55024, FCC Part 15 Subpart B Class A & Class B ICES-003 Class B, VCCI Class B, C-tick AS/NZS CISPR 22 Class B, KCC KN22 Class B, KN24, IEC/EN/UL 60950-22
General		Weight	AXIS T93F05: 1.1 kg (2.4 lb) AXIS T93F20: 1.2 kg (2.6 lb)
Supported cameras	AXIS P13 Series, AXIS Q16 Series	Included accessories	AXIS T94Q01A Wall Mount, AXIS Connector Guard A AXIS Cable Gaskets M20, Screw bit T30, Installation Guide Required tool: Torx screwdriver T20 AXIS T93F20: Angled network cable (15 cm/5.9 in)
Casing	IP66- and NEMA 4X-rated, IK10 impact-resistant polymer enclosure Color: White NCS S 1002-B	Warranty	Axis 3-year warranty, see www.axis.com/warranty
Power	AXIS T93F20: Power over Ethernet IEEE 802.3af/802.3at Type 1 Class 3, max. 15.4 W	More information is available at www.axis.com	
Connectors	AXIS T93F20: RJ45 for 10BASE-T/100BASE-TX PoE		
Environment	Indoor/outdoor		
Operating conditions	-40 °C to 60 °C (-40 °F to 140 °F) Humidity 15-100% RH (condensing) AXIS T93F05: With AXIS P13/Q16 Series: 0 °C to 45 °C (32 °F to 113 °F) AXIS T93F20: With AXIS P13/Q16 Series: -40 °C to 45 °C (-40 °F to 113 °F)		

Dimensions

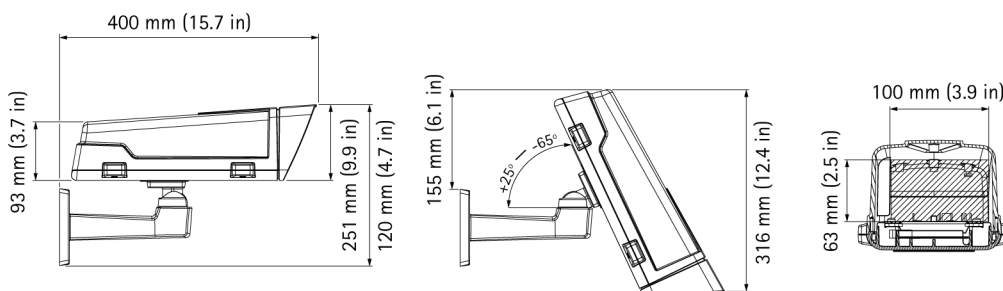

Optional accessories

1. AXIS T94R01P Conduit Back Box
2. AXIS T91A47 Pole Mount
3. VT Corner Mount WCWA
4. AXIS Sunshield A
5. AXIS Corridor Format Bracket A
6. AXIS Door Switch A
7. For more accessories, scan QR code¹.

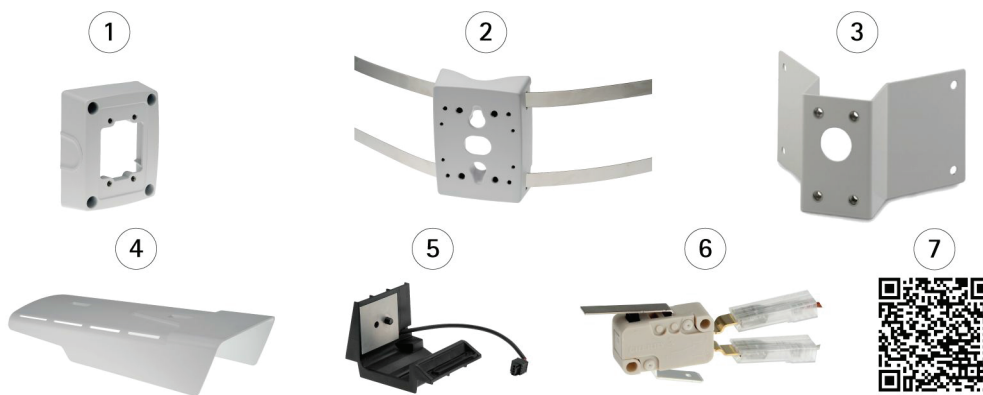

1) http://www.axis.com/products/cam_acc/mounting/camera_housing/fixed_cameras/t93f/